

# Replacement Fan Tray Instructions

## *for the ProCurve Series zl Switches*

---

The fan tray is hot swappable. It can be removed and replaced without removing power from the switch. However, install the new fan tray immediately (within two minutes) after removing the old fan tray to avoid overheating and a switch shutdown (within three minutes).

1. Release the retaining screws
2. Grasp the handle and remove the old fan tray
3. Install the new fan tray
4. Tighten the retaining screws

---

### **WARNING**

**To avoid contact with spinning fans, if you are hot swapping out the fan tray assembly, pull the assembly out one-inch and allow the fans to stop rotating (approximately 20 seconds) before pulling it all the way out.**

---

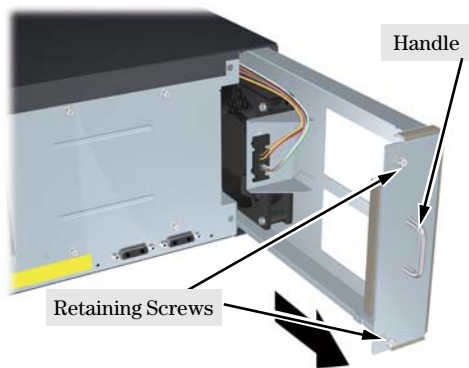

**Figure 1. 5406 Fantray being removed**

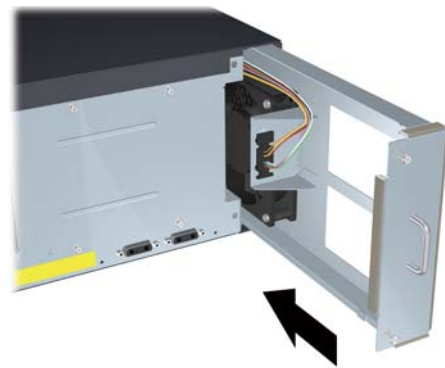

**Figure 2. 5406 Fantray being installed**

---



Figure 3. 8212 Fantray being removed



Figure 4. 8212 Fantray being installed

© Copyright 2007 Hewlett-Packard Development Company, LP. All rights reserved. The information contained herein is subject to change without notice.

This document contains proprietary information, which is protected by copyright. No part of this document may be photocopied, reproduced, or translated into another language without the prior written consent of Hewlett-Packard.

Technical information in this document is subject to change without notice.



Part Number: 5991-8554  
August 2007  
Printed in Singapore

